

Mediana Polaris key lock - 90 mm centre, 18 mm forend

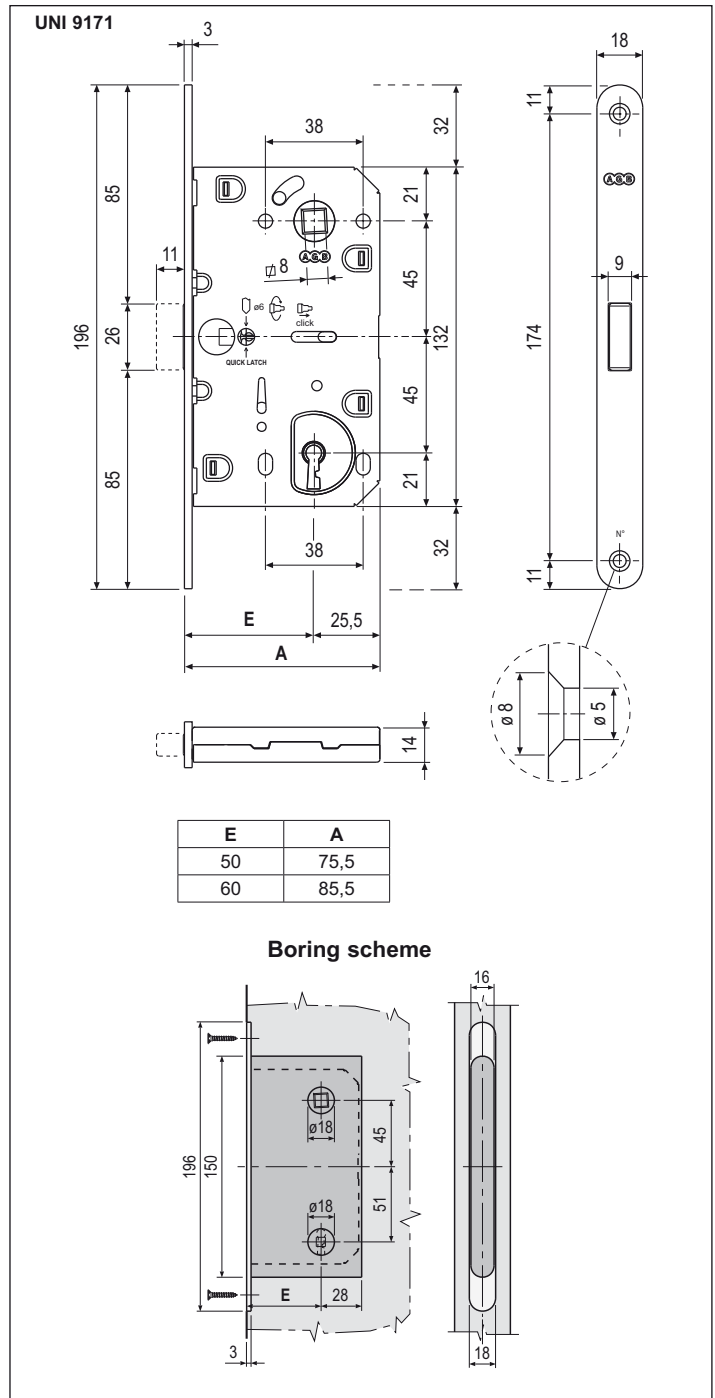

Description

Magnetic flush-mounted lock with polyamide reversible latch, with finish.
 The key blocks the latch also functioning as bolt but leaving the handle free.
 The lock features no protuberances on the forend, thanks to the latch which is entirely retracted into the casing. Steel front (18 mm) with rounded edge, 50 and 60 mm inlet. Centre, 90 mm.
 Perfect interchangeability with Mediana Evolution, allows replacing it in the existing millings. Key lock version with 4 differs available. Bored steel casing for handles mounting by means of through screws. Latch retractable also by means of key.

Application

The symmetrical, magnetic latch renders the lock right/left handed.

Mounting

Cut a slot and include a milled component on the panel (dimensions in drawing). Fix the lock with two screws (3,5x20 mm).

NB. Special packaging with only one key differ inside are available on request for industrial applications.

Order Specifications

Material	Article	Key
STEEL	B04101.50.XX	4
	B04101.60.XX	4

NB. Refer to the price list in force to check the availability of the finishes.